

WBTH-440

Instruction Manual

Specifications Description

Solution for speaker microphone with Bluetooth & Wireless pairing



INSIDE LOOK

Diagram with Annotations

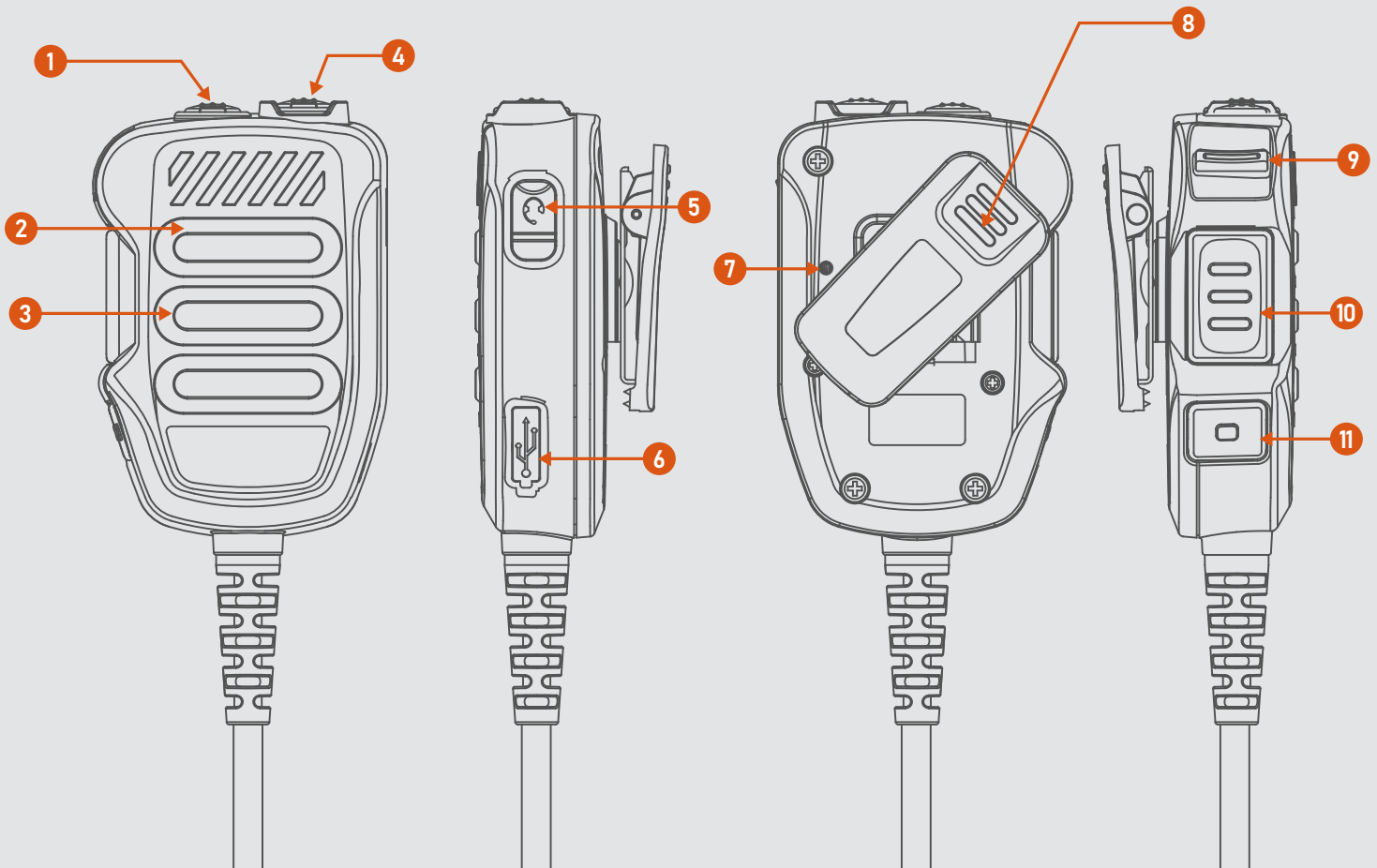

FUNCTION DESCRIPTION

- 1** Function Button (Programmable)
- 2** Microphone
- 3** Speaker
- 4** Bluetooth Function Control Button
 - Power on/off.
 - Long press to turn on Bluetooth, with a continuous press duration of 1.5 seconds.
 - Long press to turn off Bluetooth, with a continuous press duration of 3 seconds.
 - Play/Pause Music.
 - Answer/hang-up phone call.
- 5** 3.5mm External Female Socket
 - Can connect to 3.5mm Plug mono headset.
- 6** USB Type-C Charging Port
 - Charging Voltage: 5V
 - Charging Current: 500mA
 - Charging Time: 1-2 hours

FUNCTION DESCRIPTION

7 Wireless Pairing icon

- Pairing with wireless PTT WP01

8 Back Clip

- The upper clip of the back clip is made of lightweight plastic steel material, and its design can be fixed with hooks and brackets.
- The lower clip of the back clip is made of reinforced stainless-steel material and uses a high-torque spring to enhance the overall clamping force of the back clip.
- The rotating base is made of reinforced stainless-steel material and can rotate 360°, with clearly tactile angle positioning grooves.

9 Volume Button

- Push the volume button up to increase the volume (+), and push it down to decrease the volume (-).

10 Side PTT(Push-To-Talk)

- Press to activate PTT – LED light turns Green.
- Release to deactivate PTT – Green LED light turns off.

11 Noise-Canceling Button

- Press once to turn on Microphone Cancelling
- Press once to turn off Microphone Cancelling



FUNCTION SUMMARY

The WBTH-440 is a handheld microphone that can connect to both a two-way radio and a mobile phone simultaneously.

- Wired connection to the two-way radio and wireless connection to the mobile phone (wireless connection via Bluetooth).
- Volume adjustment for both the two-way radio and mobile phone is synchronized.
- During radio transmissions (TX) the WBTH-440 gives priority to the two-way radio. Audio from the mobile device is automatically muted.
- Two-way radio communication takes priority.
- PTT button indicator light.
- Microphone noise cancellation function.
- Wireless PTT functionality.
- Each wireless PTT session must not exceed 52 seconds; it will automatically end if the time limit is exceeded.
- Bluetooth supports phone calls and music playback.
- Bluetooth voice prompts available in English and Chinese (default is English).
- 3.5mm female audio jack supports CTIA headsets, stereo headphones, and mono headsets.
- Bluetooth low battery alert tone sounds every 30 seconds.
- Bluetooth pairing success tone.
- Bluetooth disconnection/reconnection prompt tone.
- Bluetooth incoming call prompt tone.
- USB-C charging port.
- Replaceable back clip.

PAIRING WITH DEVICES

Diagram with Annotations

PAIRING MOBILE PHONE VIA BLUETOOTH

Pair the WBTH-440 with your mobile phone via Bluetooth and use it to make and receive calls.

Step 1

Connect the WBTH-440 to your two-way radio and power on the radio. Ensure the WBTH-440 is in an active state.

Step 2

Press and hold the WBTH-440's Bluetooth Function Control Button for a few seconds. You will hear the 「Power On」 tone, followed by the 「Pairing」 tone.

Step 3

Enable the Bluetooth function on your mobile phone and locate "WBTH-440" in the device list. Tap to connect.

Step 4

The WBTH-440 will emit a 「Connected」 tone, indicating successful pairing.



WP01 PAIRING

- Before starting the pairing process, locate the pairing icons on both the WP01 and the device (Speaker Microphone).
- Follow the pairing steps on the next page.



Pairing Step 1 : Align Pairing Icons and Observe Lights

Bring the pairing icon on the WP01 close to the pairing icon on the H-440, keeping them tightly aligned.

- The red light on the right will turn on (about 3 seconds)
- Then the green light on the left will turn on



Pairing Step 2 : Separate the Devices and Press the PTT Button

Once the green light turns on, remove the WP01 from the H-440 and immediately press the PTT button on the WP01 once.



Pairing Step 3 : Watch the Green Light Behavior

- The green light will start blinking
- Then turn solid for about 10 seconds
- Finally, it will turn off automatically



Pairing Step 4 : Pairing Complete

Once the green light turns off, the pairing is complete and the WP01 is ready for use.

WP01 UNPAIRING

Pairing Step 1 : Align Pairing Icons

Bring the pairing icon on the WP01 close to and tightly aligned with the pairing icon on the H-440, and hold for about 10 seconds.

- The red light on the right will turn on (about 3 seconds)
- Then the green light on the left will turn on



Pairing Step 2 : Wait for Green Light to Blink and Turn Off, Then Remove

Once the green light starts blinking and turns off, remove the WP01 from the H-440 – unpairing is complete.



WP01 BATTERY REPLACEMENT

- Prepare a CR2032 battery
- Prepare a tooling (like pen, key, don't use too sharp one to avoid to damage the PCB) to assist in removing the battery.



Step 1

- Rotate the WP01 top cover counterclockwise.

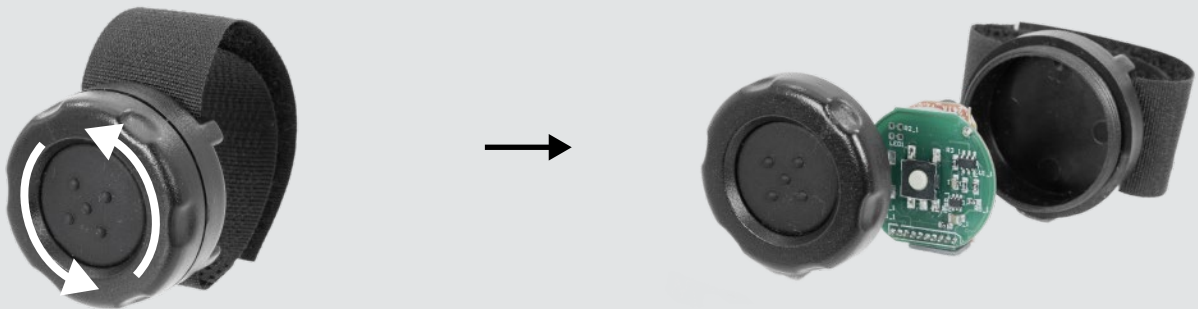

Step 2

- Use the tooling (like pen, key, don't use too sharp one to avoid to damage the PCB) to push the battery out from the indicated arrow direction.
- Please use a qualified CR2032 battery.

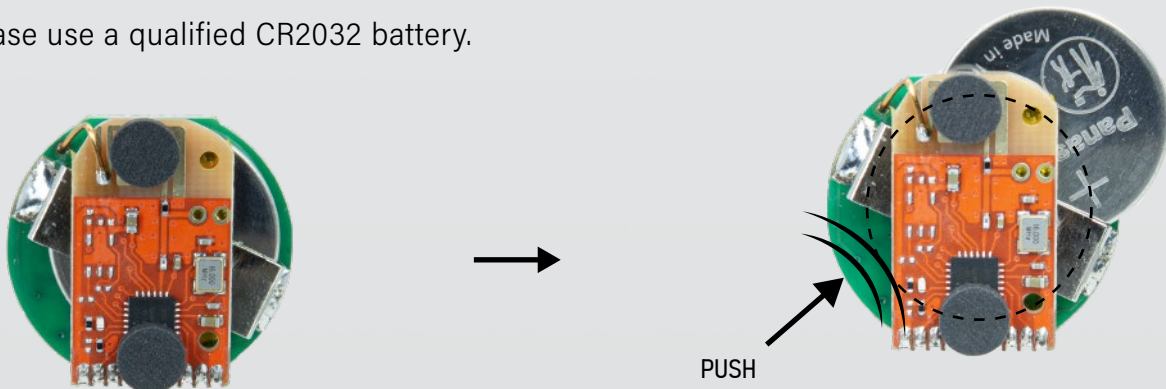

Step 3

- Insert the CR2032 battery into the WP01.
- **Align the battery with the (+) terminal facing the red PCB and the (-) terminal facing the green PCB (as shown in the diagram below).**
- Please do not insert the battery with incorrect polarity, as this may not working well or cause malfunction.

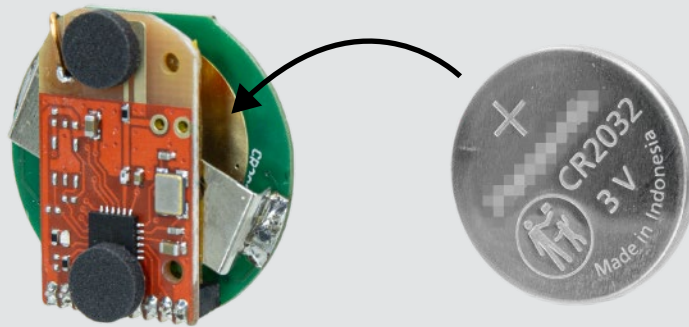

Step 4

- After installing the battery, press the PTT button (FIG.1) and check if the LED (FIG.2) will lights up. When you press the PTT, the blue LED light will turn on with a blue indicator. If the light does not turn on after pressing the PTT button, please check whether the battery is installed correctly. Or the positive and negative poles of the battery are in the correct position.

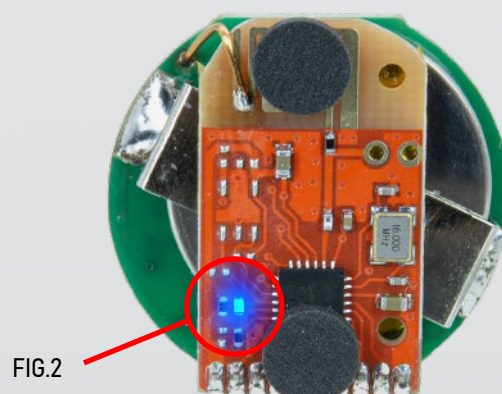
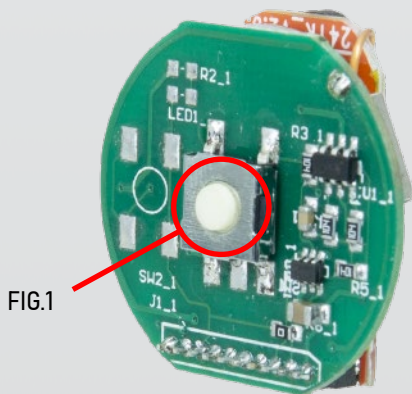

PERFORMANCE SPECIFICATIONS

BLUETOOTH VERSION	V 5.0
WALKIE-TALKIE POWER SUPPLY VOLTAGE	3.6V-7.5V
BATTERY SUPPLY VOLTAGE	3.3V-4.2V
BATTERY CAPACITY	3.7V 500mAh
CHARGING CURRENT	500mA
AMPLIFIER OUTPUT POWER	2W

MICROPHONE SPECIFICATIONS

DIMENSION	6x5(mm)
SENSITIVITY	-40±3dB
DIRECTIONALITY	OMNIDIRECTIONAL

SPEAKER SPECIFICATIONS

DIMENSION	Φ36 mm
IMPEDANCE	8Ω ± 15%
S.P.L (SOUND PRESSURE LEVEL)	100 ± 3dB
POWER RATING	Normal 1.0W, Maximum 1.5W
FREQUENCY RANGE	320Hz-14,000Hz

IP RATING	IP68
-----------	------

