

Nominal Voltage \_\_\_\_\_ 12 volts

Amp hour capacity at 20 hour rate \_\_\_\_\_ 33 amp hour

Reserve Capacity at 25 amp discharge rate \_\_\_\_\_ 50 minutes

Reserve Capacity at 15 amp discharge rate \_\_\_\_\_ 93 minutes

Reserve Capacity at 8 amp discharge rate \_\_\_\_\_ 185 minutes

Dimensions (inches) \_\_\_\_\_ Length=7.71\*, Width= 5.18, Height= 6.89\*

Dimensions (mm) \_\_\_\_\_ Length=196, Width=132, Height=175

Weight \_\_\_\_\_ 24pounds / 10.9 kilograms

Recommended charge voltage \_\_\_\_\_ Bulk Charge 14.2 – 14.6 volts

\_\_\_\_\_ Absorption/Acceptance Charge 14.2 – 14.6 volts

\_\_\_\_\_ Float Charge 13.1 to 13.4 volts

Recommended Charge Amperage \_\_\_\_\_ Up to 100% of the rated amp hour capacity

Self Discharge Rate \_\_\_\_\_ 2% per month at 77°F (25°C)

Operating Temperature \_\_\_\_\_ -50° to 150° F (-45 to 65.5 C)

Cycle life \_\_\_\_\_ 1,100 cycles to 50% DOD, 500 cycles to 100% DOD

Warranty \_\_\_\_\_ Refer to manual for warranty information by application

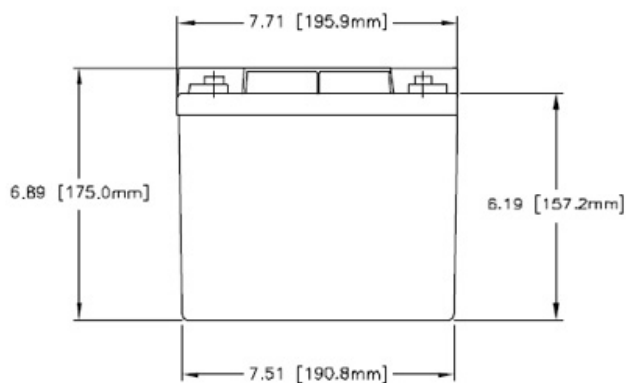

GPL-U1T

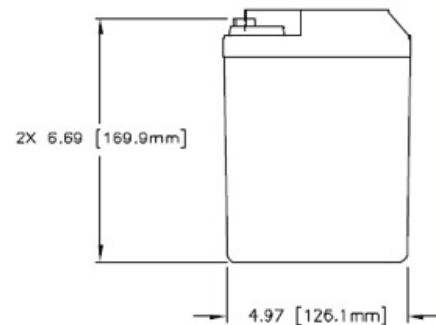

\* All dimensions are overall. This will include handles and terminals. Actual case size may be smaller than published.

**SETRONIC**  
+ —  
[www.lifeline-batterien.de](http://www.lifeline-batterien.de)

Denmark:  
SETRONIC  
Industrivej 13  
DK-6330 Padborg  
Tel.+45 7555 2366  
Fax.+45 7555 2040

Germany:  
SETRONIC  
Oluf Samson Gang 28  
D-24939 Flensburg  
Tel.+49 (0)461 5057203  
Fax.+49(0)461 4308748